

HIGHLAND 23

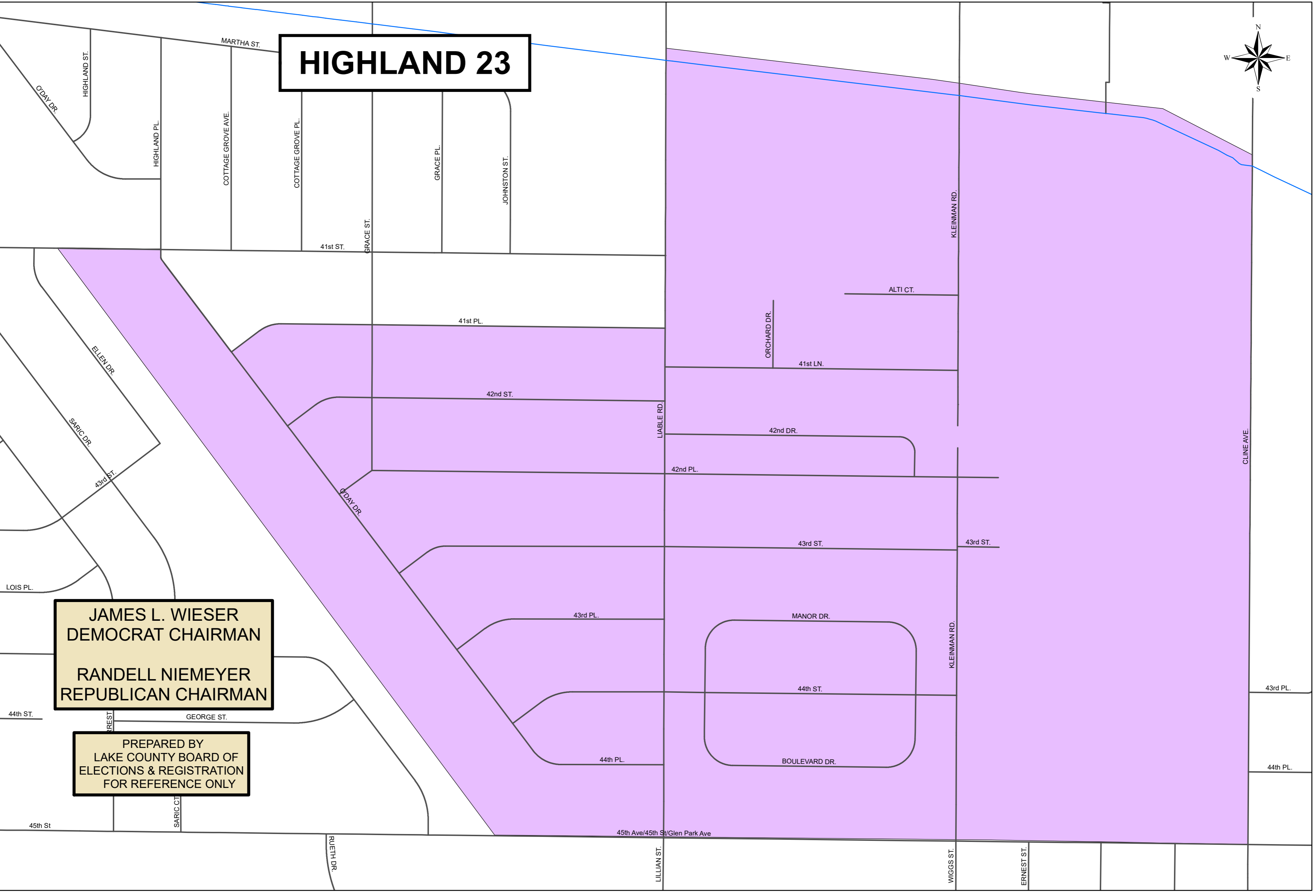
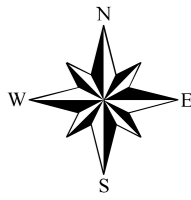

JAMES L. WIESER
DEMOCRAT CHAIRMAN

RANDELL NIEMEYER
REPUBLICAN CHAIRMAN

PREPARED BY
LAKE COUNTY BOARD OF
ELECTIONS & REGISTRATION
FOR REFERENCE ONLY

MARTHA ST.
HIGHLAND ST.
ODDY DR.
HIGHLAND PL.
COTTAGE GROVE AVE.
COTTAGE GROVE PL.
GRACE PL.
JOHNSTON ST.
41st ST.
GRACE ST.
41st PL.
42nd ST.
42nd DR.
42nd PL.
43rd ST.
43rd PL.
44th ST.
44th PL.
45th St
SARIC DR.
HIGHLAND ST.
COTTAGE GROVE AVE.
COTTAGE GROVE PL.
GRACE PL.
JOHNSTON ST.
GRACE ST.
41st PL.
42nd ST.
42nd DR.
42nd PL.
43rd ST.
43rd PL.
44th ST.
44th PL.
45th St
SARIC DR.
HIGHLAND ST.
COTTAGE GROVE AVE.
COTTAGE GROVE PL.
GRACE PL.
JOHNSTON ST.
GRACE ST.
41st PL.
42nd ST.
42nd DR.
42nd PL.
43rd ST.
43rd PL.
44th ST.
44th PL.
45th St
SARIC DR.

ODDY DR.
ELEN DR.
SARIC DR.
43rd ST.
LOIS PL.
44th ST.
SARIC CT.
RUETH DR.
45th Ave/45th St/Glen Park Ave

LIABLE RD.
ORCHARD DR.
41st LN.
42nd DR.
42nd PL.
43rd ST.
43rd PL.
44th PL.
LILLIAN ST.

ALTI CT.
KLEINMAN RD.
KLEINMAN RD.
MANOR DR.
BOULEVARD DR.
WIGGS ST.
ERNEST ST.

CLINE AVE.
43rd PL.
44th PL.